



PART DESCRIPTION:
CLP SERIES UV DISINFECTOR

TOLERANCES UNLESS OTHERWISE SPECIFIED
FRACTIONS ± 1/4" ANGLES ± 1°

REV# 000 SCALE: 1"=1'
DIMENSIONS ARE IN INCHES UNLESS OTHERWISE SPECIFIED

DATE: 8/30/12 PART# ---

DRWNR BY: A.DAVIS

SHEET# 1 OF 1

300-1500 TOTAL VOLUME
PRETREATMENT TANK

CLP SERIES
500-1500 GPD

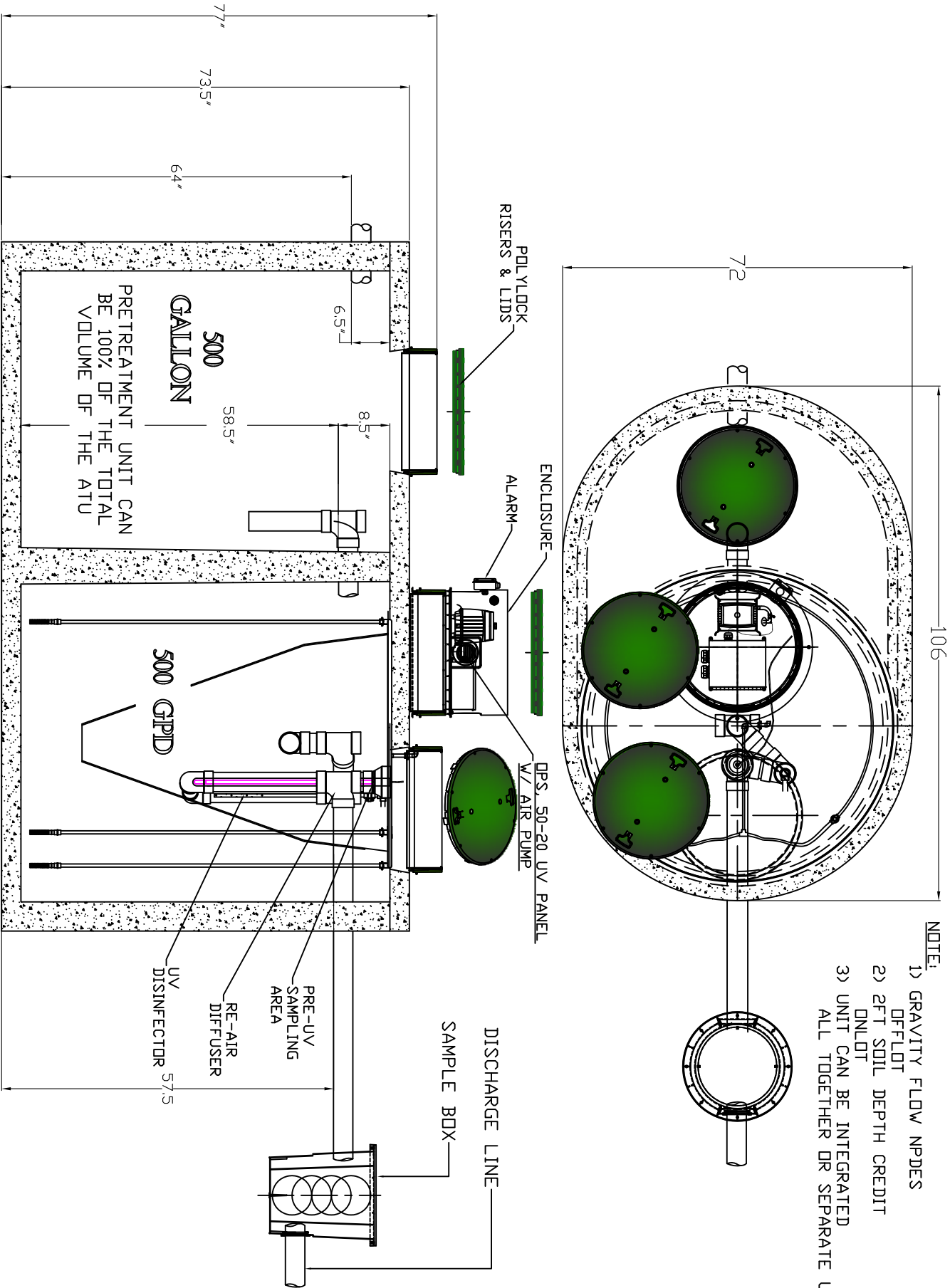

- NOTE:
- 1) GRAVITY FLOW NPDES DFLOTT
 - 2) 2FT SOIL DEPTH CREDIT DNLOTT
 - 3) UNIT CAN BE INTEGRATED ALL TOGETHER OR SEPARATE UNITS